

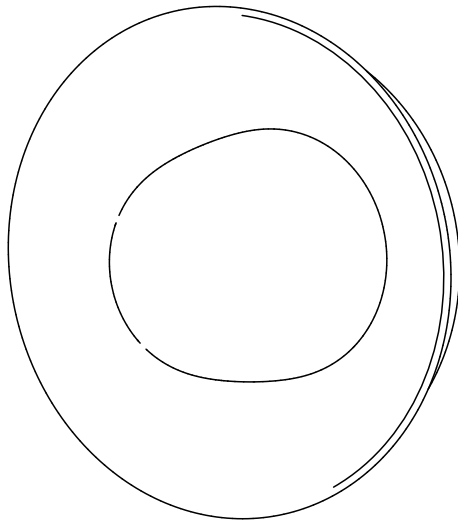

Hoist Sconce

12741 rC

AC Input



CAUTION:

Before starting, turn off power at main circuit panel.

ADVERTENCIA:

Antes de comenzar la instalación, apague la corriente en el tablero principal.

ATTENTION:

Coupez l'alimentation avant de procéder à l'installation.



Calling for backup? Scan above to contact our team.

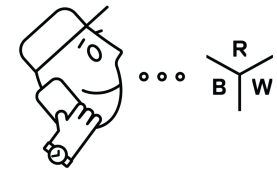

www.RBW.com

+1 212 388 0399

support@RBW.com

© RBW Studio LLC, 2013, 2020

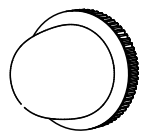

Bare

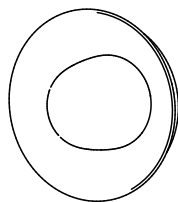

Small Shade

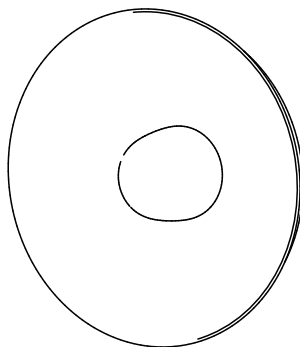

Medium Shade

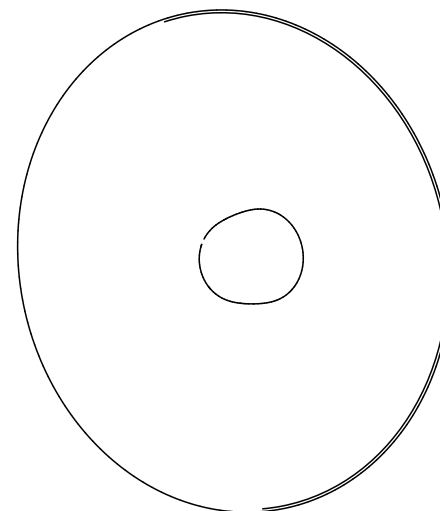

Large Shade

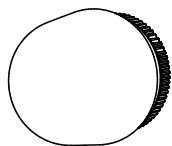

Bare

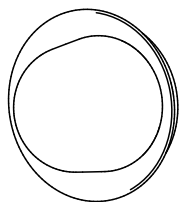

Small Shade

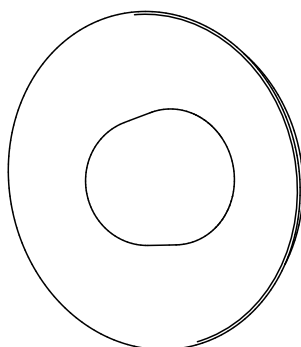

Medium Shade

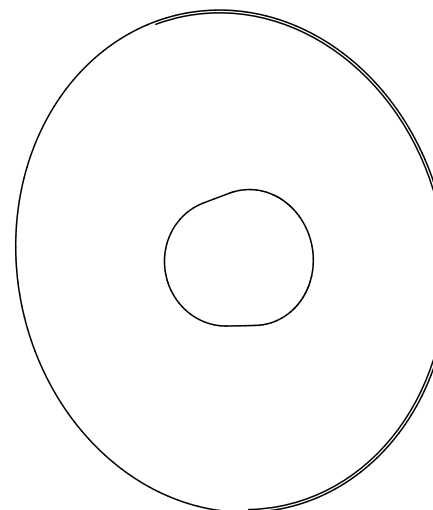

Large Shade

What's Included: Part Configurations May Vary

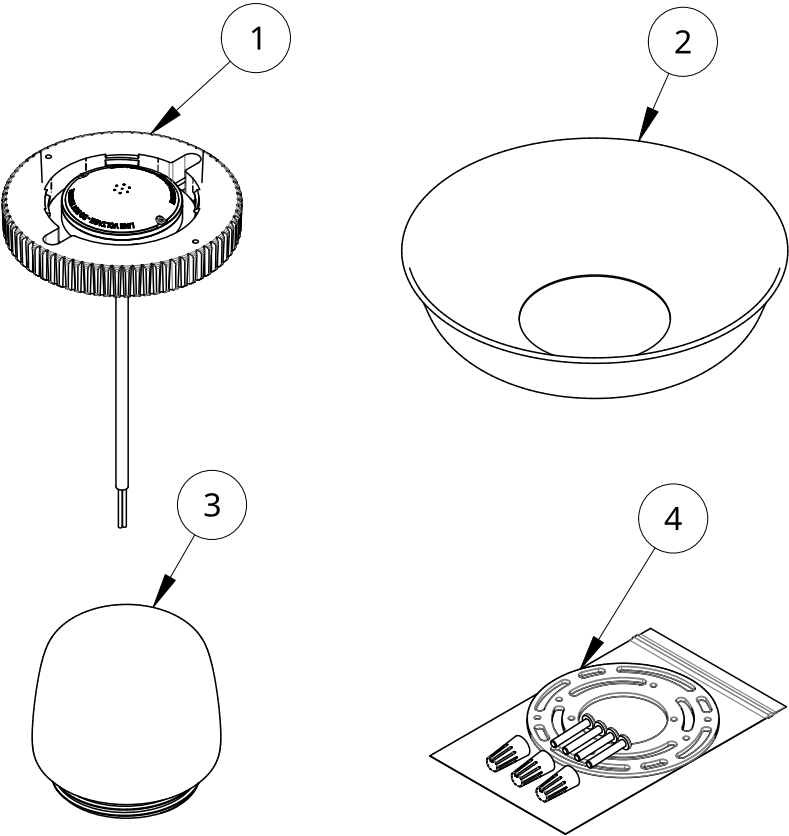

Item	Qty	Part number	Description
1	1	10175-PC30	Hoist Sconce Module Sub-Assembly. 120 AB. Matte Black
2	1	10183-PC30	Hoist Small Shade w/ Gasket. Matte Black
3	1	11659	Hoist Glass Small
4	1	11861	Hoist Sconce Hardware Kit

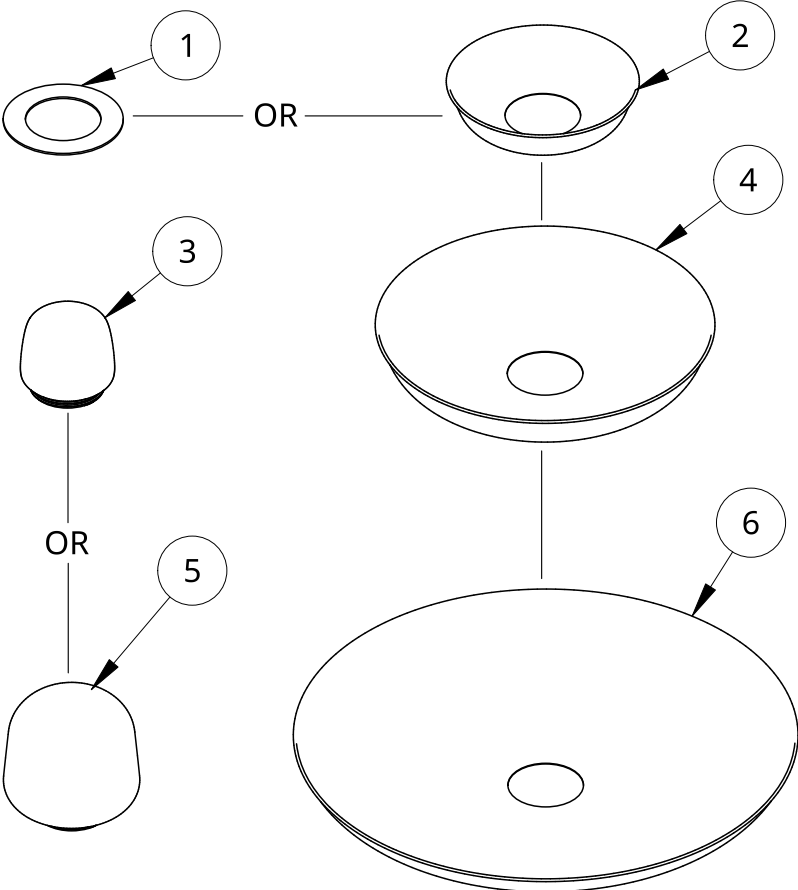

NOTE: Sconce Plate included when a shade is not used.

Item	Qty	Part number	Description
1	1	11678-PC30	Hoist Sconce Plate. Matte Black
2	1	10183-PC30	Hoist Small Shade w/ Gasket. Matte Black
3	1	11659	Hoist Glass Small
4	1	10184-PC30	Hoist Medium Shade w/ Gasket. Matte Black
5	1	11683	Hoist Glass Large
6	1	10185-PC30	Hoist Large Shade w/ Gasket. Matte Black

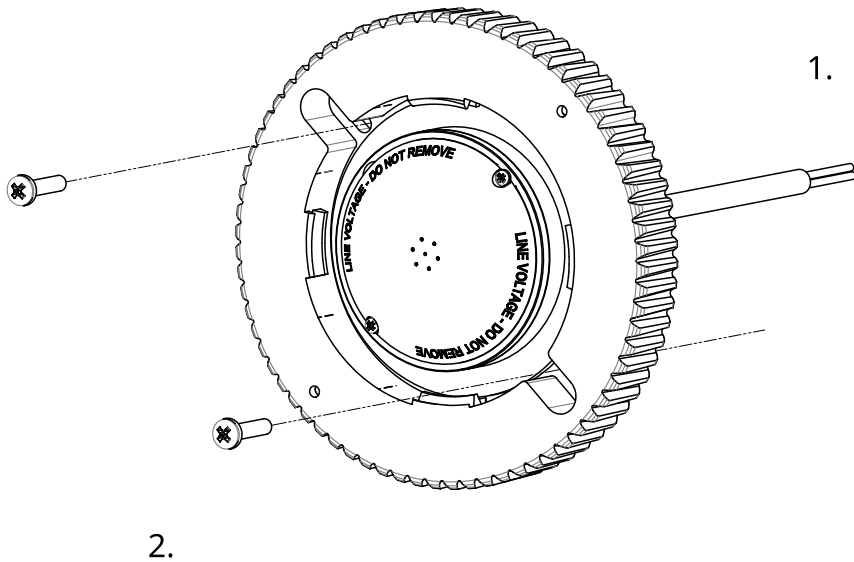

Installation - LED Mount Module Assembly

1. Connect White (L) and Black (N) Sconce wires to power feed.
2. Fix the Module to desired mounting surface with appropriate fasteners.

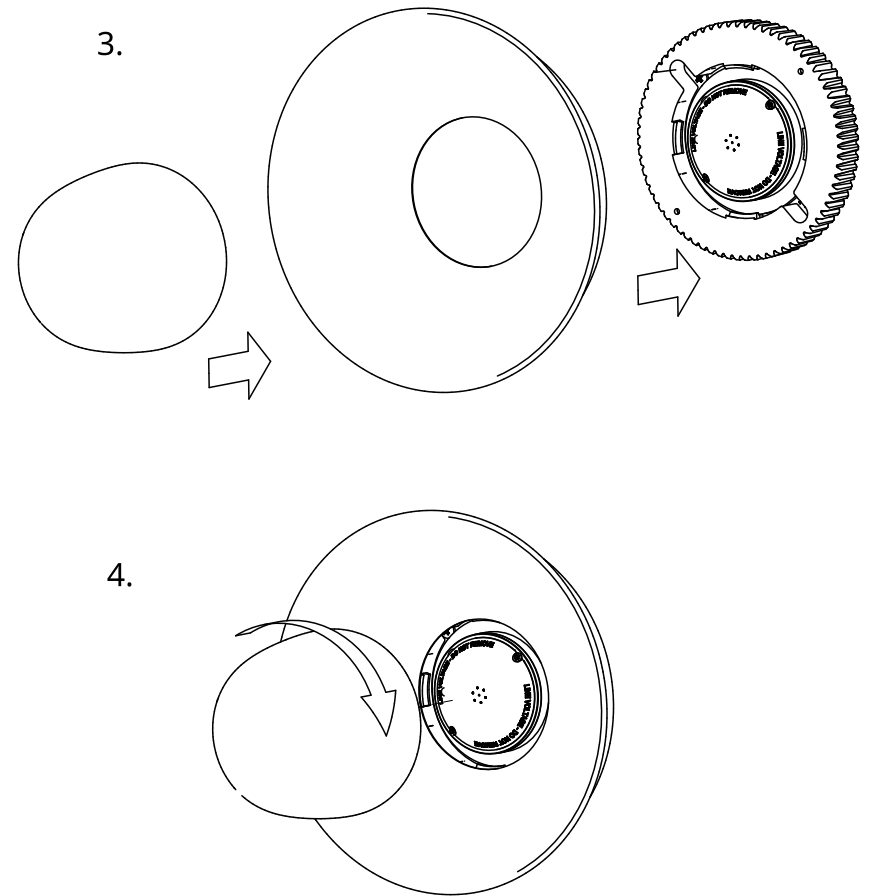

Installation - Shade and Globe

3. Place the Shade w Gasket on LED Mount Module and thread Hoist Globe through Shade.
4. Securely fasten Hoist Globe to LED Mount Module to ensure a tight seal.
5. Congratulations! End of guide.